

## 12 MONTH WARRANTY

In Australia our goods come with guarantees that cannot be excluded under the Australian Consumer Law. You are entitled to a replacement or refund for a major failure and for compensation for any other reasonably foreseeable loss or damage. You are also entitled to have the goods repaired or replaced if the goods fail to be of acceptable quality and the failure does not amount to a major failure.

In New Zealand our goods come with guarantees that cannot be excluded under the Consumer Guarantees Act 1993. So, as well as your statutory rights referred to above and any other rights and remedies you may have under any other laws relating to your Kylin product, we also provide you with a Kylin warranty. It's important to note that this warranty is valid only in the country of purchase.

Kylin guarantees this product against defects caused by faulty workmanship and materials for 12 months domestic use (or 3 months commercial use) from the date of purchase. During this warranty period, Kylin will repair any defective product. If the product includes a number of accessories, only the defective part or accessory will be replaced. Kylin reserves the right to make minor adjustments instead of replacing the product or accessory. Packaging, instructions, recipes etc will also not be replaced unless faulty.

In the event of a product or accessory being replaced during the warranty period, the warranty on the replacement product will expire 12 months from the purchase date of the original product, not 12 months from the date of the replacement.

To the extent permitted by law, this Kylin 12 months warranty excludes liability for consequential loss or any other loss or damage caused to property or persons arising from any cause whatsoever. It also excludes defects caused by the product not being used in accordance with Instructions, accidental damage, misuse, or being tampered with by unauthorised persons, excludes breakables such as glass and ceramic items, consumable items and normal wear and tear and does not cover the cost of claiming under the warranty or transporting the goods to and from the place of purchase.

Should you suspect your product may be defective and need some clarification or advice, or you have any questions, ideas, or concerns, please contact us directly on:

**Kylin Customer Service Australia +61 (0)3 9998 0999**

If you're certain your product is defective, and the product is covered by the terms of this warranty, you need to take the defective product back to the place you purchased it from, where the retailer will replace the product for you on our behalf. In this event, per the terms of this Kylin 12 month warranty, you will need to present this portion of the warranty page and the purchase receipt as proof of purchase so please make sure you keep both this page and your receipt on hand for the duration of the warranty period.

And if for any reason you wish to contact us, please do so at:

**Kylin Customer Service Australia +61 (0)3 9998 0999**

**HKG PTY LTD**  
12/11 Mary Street, Blackburn, Australia, 3130

[www.kylinaustralia.com.au](http://www.kylinaustralia.com.au)

**Kylin®**

# Kylin®

## INSTRUCTION MANUAL

### Kylin Electric Claypot / Slow Cooker 4L

#### AU-K2022



FOR HOUSEHOLD USE ONLY

Please read this instruction carefully before using the product.

# CONTENTS

I.	IMPORTANT SAFETY PRECAUTION-----	1
II.	PARTS IDENTIFICATION-----	2
III.	CONTROL PANEL-----	3
IV.	OPERATING INSTRUCTIONS-----	4-5
V.	COOKING EXAMPLE-----	6
VI.	CLEAN AND MAINTENANCE-----	7
VII.	TROUBLESHOOTING-----	7
VIII.	CHINESE MANUAL 中文說明書 -----	8
IX.	12 MONTH WARRANTY-----	18

## 常見故障及處理

NO.	故障現象		原因	消除方法
1.	指示燈 未亮起	加熱器 不熱	未供電 PCB斷開連接 PCB損壞	檢查電源是否供電。 檢查電源綫 送到維修店。
		加熱器 燙熱	PCB 損壞	送到維修店
2.	指示燈 亮起	加熱器 不熱	指溫度傳感器故障。 加熱元件損壞。 PCB斷開連接。 PCB損壞。	送到維修店
3.	不能自動保溫 或保溫異常		PCB異常 傳感器異常	送到維修店
4.	屏幕顯示“E0”		傳感器異常	送到維修店
5.	屏幕顯示“E1”		傳感器短路	送到維修店
6.	屏幕顯示“E2”		防幹燒保護	切斷電源和冷卻

## 特別注意事項避免紫砂內膽破裂

- ★ 紫砂內膽切勿用明火煮，即不可將內膽放置於明火（煤氣竈）上加熱，也不可放於電陶爐等熱源上加熱，祇能放在本產品的鍋體上加熱。
- ★ 清潔內膽須待內膽冷卻後方可清洗，不可在紫砂膽尚未冷卻時進行清洗。
- ★ 不要在熱內膽上突然加冷水，也不要冷鍋上突然加熱水。
- ★ 不可將盛有滾熱食物的內膽放於大理石或瓷磚等較冷的臺面或地板上。

## 保養和維護

1. 在清潔之前，拔下電源綫插頭并讓炖鍋完全冷卻。
2. 用溫肥皂水清洗內鍋，內蓋，外蓋，量杯和飯勺。徹底衝洗幹淨。
3. 炖鍋的主機可以用稍微柔軟的濕布擦拭。切勿使用任何化學溶劑或研磨劑清潔炖鍋。
4. 為避免電擊和故障，切勿將炖鍋浸入水中或其他液體中。
5. 儲存前，請確保炖鍋的所有部分都完全幹燥。不要將炖鍋存放在潮濕的地方，如廚房洗手盤下面。

## 溫馨提示

1. 本紫砂煲主機實行一年保修（僅適用於家庭使用的產品，紫砂內膽和紫砂蓋子不屬於保修範圍）。
2. 保修期的起始日期以產品的銷售票據日期為準，維修時請出示有效票據。
3. 以下情況均不屬於保修範圍：  
消費者使用及保管不當造成的損壞；  
由於內膽和外蓋是易碎品，不屬於保修範圍；  
非本公司指定維修部自行拆卸修理而造成損壞；  
無有效票據；  
票據所列的產品型號與實際型號不符合或者有塗改；  
因不可抗力力而造成的損壞。
4. 內膽不慎損壞，請致電03-99980999向本公司或當地維修點郵購。

## IMPORTANT SAFETY PRECAUTION

Thank you for purchasing of this appliance from Kylin, please read all the instructions carefully before using. **ALWAYS KEEP THESE INSTRUCTIONS FOR FUTURE REFERENCE.**

1. Always switch off and unplug the appliance from the main electrical supply **BEFORE** cleaning and also when the appliance is not use.
2. Never immerse the appliance in water or other liquids to avoid damage and other hazards.
3. Adult supervision is necessary when operating appliance, especially where children are present.
4. Ensure the electrical cord does not hang over the work surface.
5. Do not operate the appliance with a damaged cord set, or plug. Any repairs should always be carried out by the Customer Service Centre or by an authorized service centre.
6. Do not place the appliance on or near a hot gas or electric burner, in a heated oven, or near easily flammable materials.
7. Always place appliance on a flat sturdy surface. When moving appliance, please be cautious and not to touch hot surface. Please pay special attention when moving an appliance containing hot liquids.
8. Use of accessories or equipment not supplied by manufacturer may cause damage or result in the malfunctioning of your appliance or bodily injures.
9. This appliance is intended for household use only.
10. Do not place the inner pot directly over an open fire.
11. Do not exceed the maximum water level indicated in the inner pot to prevent overflow.
12. This appliance cannot be used by physical weak, slow response or mentally disable people (including children) unless guidance is provided during operation.

## ● PARTS IDENTIFICATION

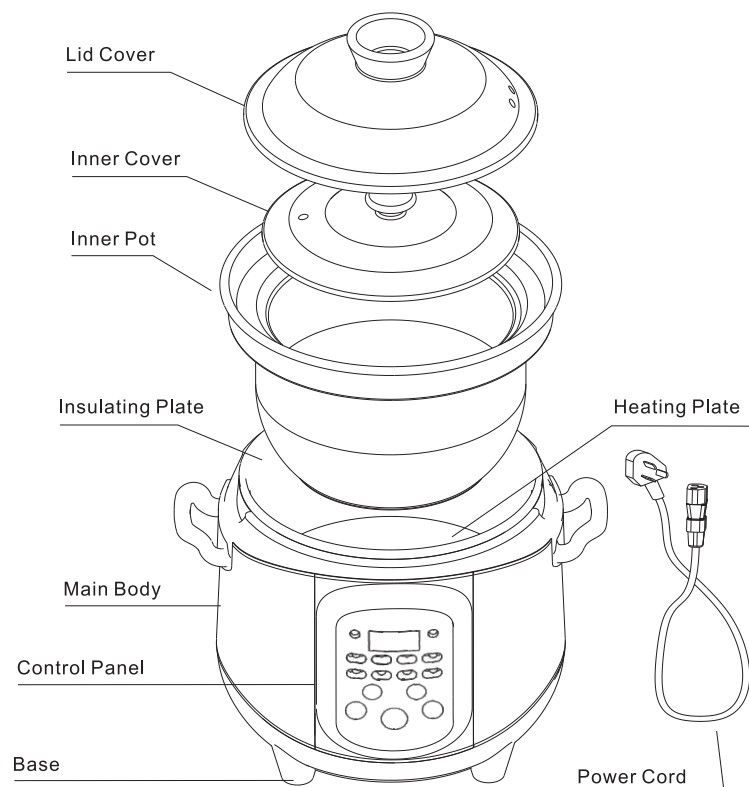

### Main Technical Parameters

MODEL NO.	AU-K2022
RATED VOLTAGE	220-240V
RATED WATTAGE	700W
FREQUENCY	50-60Hz

### 注意：

- a) 您可以根據自己的個人喜好進行調整。
- b) 建議在煮飯時使用內蓋。大米的最大量不應超過6杯。
- c) 粥的最大量不應超過1杯。

### 菜單介紹：

菜單	默認時間	菜單	默認時間
柴火飯	"-----"	燜燒	1:30
筋骨湯	3:00	紅燒	1:30
魚湯	2:00	老火湯	3:00
肉湯	2:30	薑醋/糖水	3:00
砂鍋粥	2:00	快燉	2:00
嬰兒粥	2:00	蒸煮	1:00

注意： a) "-----"表示沒有默認的烹飪時間。

b) 表格菜單中的所有默認時間可根據您的需要進行調整，除了煮飯。

### 烹飪參考說明：

#### 一. 白米飯

1. 用量杯量好需要的米量並清洗乾淨，一量杯約150克；
2. 洗淨的米放進內膽，按照比例放入適量水，其米水比例建議為1: 1；
3. 將內膽外表面擦乾淨放入鍋體內，並輕輕旋轉內膽，確保內膽與發熱盤接觸良好；
4. 選擇"米飯"烹飪功能；
5. 烹飪結束後，機器自動提示"嘟"三聲，保溫指示燈亮起，顯示屏顯示"00: 00"進入保溫狀態。
6. 最小米量為1杯米，最大米量為4杯米。

#### 二. 粥、湯

1. 將烹飪所需的所有食材處理乾淨後，一起放入內膽中，添加適量的水。  
煲粥最大米量建議不要超過0.8杯；
2. 將內膽外表面擦乾淨放進鍋體，並輕輕旋轉內膽，確保內膽與發熱盤接觸良好；
3. 選擇並確認烹飪功能；
4. 烹飪結束後，機器自動提示"."三聲，保溫指示燈亮起，顯示屏顯示"00: 00"進入保溫狀態。

#### 4. 功能選項

- 按“菜單”鍵選擇功能：選擇功能後
- 選擇功能後，按“開始/取消”鍵開始烹過程，屏幕將直接開始倒數時間。除了米飯功能，會先煮一段時間最後屏幕才顯示"00:08"开始倒数
- 選擇功能後，按“開始/取消”鍵開始烹過程，屏幕將直接開始倒數時間。除了米飯功能，會先煮一段時間最後屏幕才顯示"00:08"开始倒数

#### 5. 設置烹時間（可根據個人喜好調整烹時間，除了米飯功能。）

- 選擇所需的烹飪功能。（無需確認）；
- 按小時和分鐘鍵調整烹飪時間；
- 按“開始/取消”鍵確認烹飪時間；
- 炖鍋開始煮。

#### 6. 預設時間：預設時間範圍為1-2小時。

- 按“預設”鍵指定時間；
- 按小時和分鐘鍵調整指定時間；
- 按“小時”和“分鐘”鍵調整所需的烹飪時間；
- 按“開始/取消”鍵確認功能和烹飪時間；
- 烹飪時間將從設定的烹飪時間開始倒數。當顯屏顯示為 "00-00"時，指定時間結束，并自動開始烹飪。

#### 關於米和水的比例的建議：

功能	柴火飯	砂鍋粥	嬰兒粥
比率/米：水	1:1 ~ 1:1.1.3	1:10 ~ 1:13	1:6 ~ 1:8

#### Control Panel



#### Button Introduction

- “Function” button: Press “Function”, enter into function selection, choose as this sequence:



- “Preset” Button: Set appointment time for cooking.
- “Hour” and “Minute” button: Adjust the preset time and cooking time, increase 1 hour for every pressing “Hour” button; increase 5 minutes for every pressing “Minute” button.
- “Keep Warm/Cancel” button: Keep warm or cancel the function into the standby status. When the cooker is working with a selected function, press the “Keep Warm/Cancel” button to stop the current cooking. And under standby status, press the “Keep Warm/Cancel” button to enter into keep warm status.

## ● OPERATING INSTRUCTIONS

1. Use dry cloth to wipe the outer surface of the inner pot and the heating plate surface, and then put the inner pot into the cooker.



2. Place the food into the inner pot, pay attention should not to be over Max of the inner pot capacity.

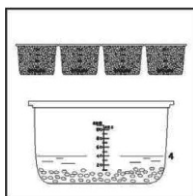

3. Turn on the power after the "Di" sound, at the same time LED display: "--:--". It represents it is in standby mode.

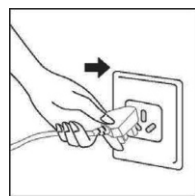

### 4. Function Selection:

- Press "Function" button for function selection.
- Choose the function, the screen flash, begins to work after 10 seconds.

### 5. Set the cooking time: (can adjust the cooking time according to personal preference, expect for the Rice function.)

- Select your desired cooking function.
- Press "Hour" and "Minute" button to adjust the cooking time.
- After the cooking time adjustment, the screen flash, begins to work after 10 seconds.

### 6. Preset time: The range of preset time is from 1-12 hours.

- Press the "Preset" button for appointing time.
- Press "Hour" and "Minute" button to adjust the appointing time.
- Press "Menu" button to choose the function.
- Press "Hour" and "Minute" button to adjust your desired cooking time.
- Press "Start/ Cancel" button to confirm the function and cooking time.
- The cooking time will count down from the set cooking time. When the display show as "00-00", the appointing time ends and it automatically to begin cooking.

## 操作說明

1. 用幹布清潔并擦幹內鍋和加熱板表面，將內鍋放入主體內。



2. 將材料放入內鍋中，加入適量的水，您可以參考表格“米和水之間比例的建議”來調整水量以適合您的個人口味。

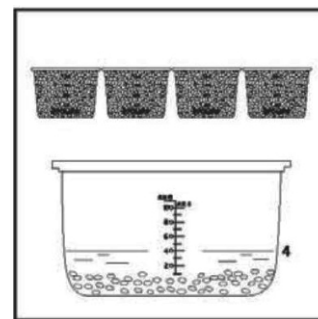

3. 連接電源，炖鍋將發出"D"聲，指示燈顯示為 "--:--"，現在處於待機模式。

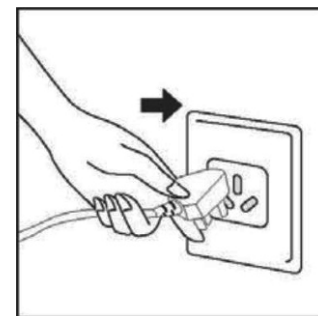



操作面板



按鍵介紹

1. “菜單，鍵：按“菜單，鍵一次，進入功能選擇。選擇序列：



2. “預約”鍵：輸入并設置烹飪時間，最短時間為1小時，最長時間為12小時。
3. “小時和分鐘”鍵：調整預設時間和烹飪時間。每按一下“小時”，增加1小時,每按一次“分鐘”，增加5分鐘。
4. “開始/取消”鍵：完成選擇功能并設置烹飪時間，按“開始/取消”開始烹飪。在烹飪過程中，除“開始/取消”鍵外，對鍵沒有任何反應。要停止烹飪過程，祇需按住“開始/取消”鍵2秒鐘即可。
5. “保溫”鍵：保持溫暖狀態。保持一定的溫度。

Suggestions for proportion between rice and water

Functions	Rice	Porridge	Baby Porridge
Rate/Rice: Water	1:1 ~ 1:1.1.3	1:10 ~ 1:13	1:6 ~ 1:8

Note:

- a) You may adjust according to your taste.
- b) Suggested to use the inner lid when cooking rice. The maximum quantity for rice should not exceeded 6 cups.
- c) The maximum quantity for porridge should not be exceeded 1 cup.

Function introduction

Menu	Default Time	Menu	Default Time
Rice	“----”	Porridge	1:30
Soup	“----”	Stew	3:00
Slow Cook	3:00	Dessert	2:00

Note:

- a) “----” indicates that there is not default cooking time.
- b) All the default time in the table menu can be adjust according to your desired expect the rice cooking.

Suggestions for proportion between rice and water

Functions	Rice	Porridge	Baby Porridge
Rate/Rice: Water	1:1 ~ 1:1.1.3	1:10 ~ 1:13	1:6 ~ 1:8

## ● COOKING REFERENCE

### Rice

- The rice amount is required and cleaned, and a measuring cup is about 150g.
- Put the washed rice into the inner pot, put the appropriate amount of water according to the proportion, the ratio of rice to water is recommended to be 1:1.
- Wipe the outer surface of the inner pot, then put it into the cooker and gently rotate the inner pot to ensure that the inner pot is in good contact with the heating plate;
- Select the "rice"cooking function;
- After the cooking is finished, the machine automatically prompts "beep"three times, the keep warm indicator lights up, and the display shows "00:00"enter into the keep warm status.
- The minimum amount of rice is 1 cup, and maximum is 4 cups.

### Claypot Rice

- The rice amount is required and cleaned, and a measuring cup is about 150g;
- Put the washed rice into the inner pot, put the appropriate amount of water according to the proportion, the ratio of rice to water is recommended to be 1:1.
- Wipe the outer surface of the inner pot, then put it into the cooker and gently rotate the inner pot to ensure that the inner pot is in good contact with the heating plate.
- Select the "clay pot rice"cooking function.
- During the cooking process, the prompt "beep"three times in about 30 mins after cooking, indicating that you can put the ingredients into the inner pot, and quickly put in to avoid the ingredients cannot be cooked.
- After the cooking is finished, the machine automatically prompts"beep"five times, the keep warm indicator lights up,and the display shows"00:00"into the keep warm status.

### Porridge and Soup

- Dispose of all the ingredients needed for cooking, put them into the inner pot together, and add the right amount of water. The maximum amount of rice for porridge is recommended not to exceed 0.8 cup.
- Wipe the outer surface of the inner pot, then put it into the cooker and gently rotate the inner pot to ensure that the inner pot is in good contact with the heating plate.
- Select the "soup"cooking function.
- After the cooking is finished, the machine automatically prompts"beep" three times, the keep warm indicator lights up, and the display shows"00:00"enter into the keep warm status.

## 產品結構

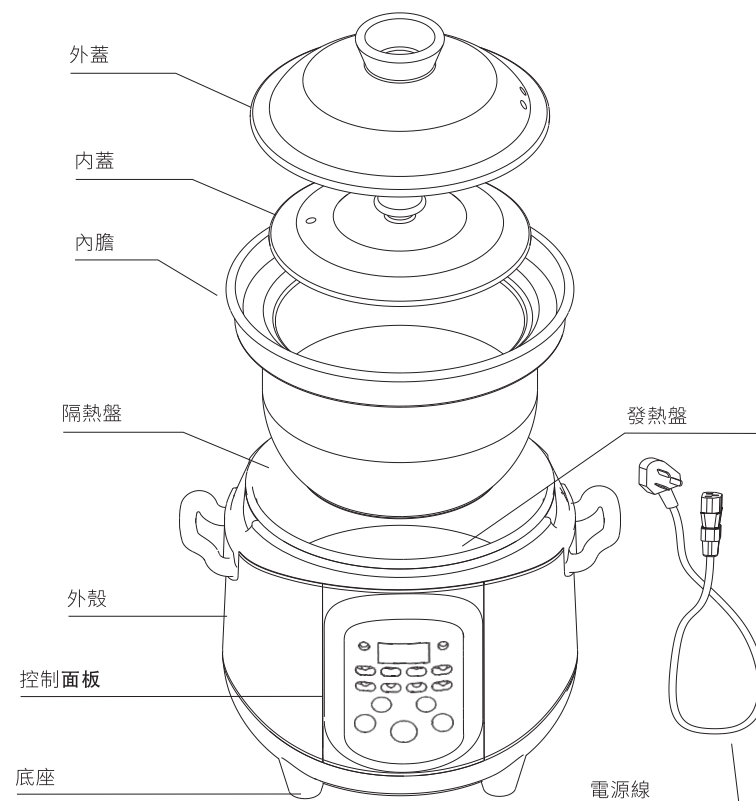

## 產品規格

型號	AU-K2022
電源	220-240V
功率	700W
頻率	50-60Hz



## 安全注意事項

感謝你購買麒麟 **Kylin** 產品，請在使用前仔細閱讀所有說明。請保留此說明書以供將來參考。

1. 在清潔之前以及不使用本產品時，務必關閉本產品並從主電源上拔下電源插頭。
2. 切勿將本產品浸入水中或其他液體中，以免造成損壞和其他危險。
3. 操作本產品時，務必有成人在旁監督，尤其是兒童在場時。
4. 確保電源線沒有懸掛在產品表面上
5. 請勿使用損壞的電線組件或插頭操作本產品。任何維修動作都應該由公司客戶服務中心或授權服務中心處理。
6. 請勿將本產品放置在熱氣體或電子燃燒器上或附近，加熱爐中或易燃易燃材料附近。
7. 始終將設備放在平坦堅固的表面上。移動設備時，請務必小心不要接觸熱表面。移動裝有熱液體的器具時必須格外小心。
8. 使用非制造商提供的附件或設備可能會造成損壞或導致設備故障或人身傷害。
9. 本產品僅供家庭使用。
10. 不要將內鍋直接放在明火上煮食物。
11. 不要超過內鍋中指示的最高水位以防止溢出。
12. 除非在操作過程中提供指導，否則身體虛弱，反應緩慢或精神殘疾的人（包括兒童）不能使用本產品。

## ● CLEAN AND MAINTENANCE

1. Unplug the power cord and allow the stew cooker to cool completely before cleaning and maintenance.
2. Wash the inner pot, inner lid, lid cover, measuring cup and rice spoon with warm soapy water. Rinse and dry thoroughly.
3. The main body of the stew cooker can be wiped with a slightly soft damp cloth. Never use any chemical or abrasive solution to clean the stew cooker.
4. Please do not immerse the stew cooker in water or other liquid to avoid electric shock and malfunction.
5. Before storage, please ensure that all parts of the stew cookers are completely dried. Do not store the stew cooker in damp areas such as under the kitchen washing basin.

## ● TROUBLESHOOTING

NO.	Fault phenomenon		Cause	Elimination method
1.	The indicator is not on	The heater is not hot	Power is not supplied PCB is disconnected PCB is damaged	Check if the power is supplied. Check the power cord and send to the repair shop
		The heater is not hot	PCB is damaged	Send to the repair shop
2.	The indicator is on	The heater is not hot	The temperature sensor is failure. Heating element is damaged. PCB is disconnected. PCB is damaged.	Send to the repair shop
3.	Can't keep warm automatically or keep warm is abnormal		PCB is abnormal. Sensor is abnormal.	Send to the repair shop
4.	Screen show "EO"		Sensor is abnormal.	Send to the repair shop
5.	Screen show "E1"		Sensor is short-circuit	Send to the repair shop
6.	Screen show "E2"		Anti-dry protection	Cut off the power and cooling

### Special Notice for Use:

1. Do not put the inner pot directly on the flame fire & infrared cooker for cooking.
2. Cleaning the tank after cooking to avoid shrink and burst.
3. Do not clean when the pot is hot.
4. Do not put the pot on the cold table or floor directly when it is hot.

# Kylin

## 使用說明

Kylin麒麟多功能雙蓋紫砂慢燉煲4L

型號：AU-K2022

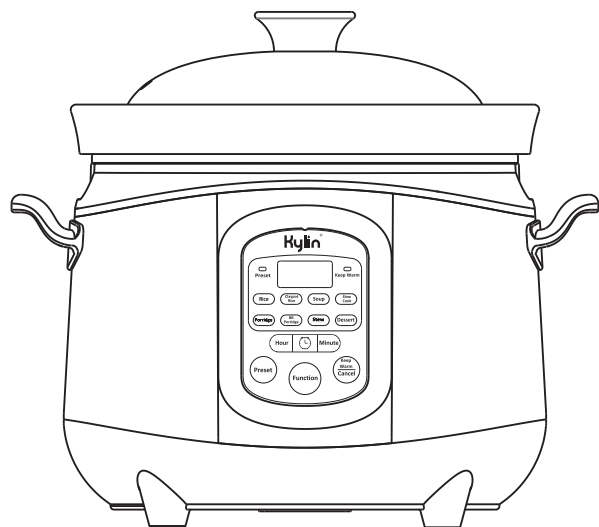

僅供家庭使用  
使用產品前，請仔細閱讀本說明書

## 目錄

一. 安全注意事項-----	10
二. 產品規格-----	11
三. 操作面板-----	12
四. 使用方法-----	13-15
五. 保養及維護-----	16
六. 常見故障及處理-----	17
七. 保修事項-----	18